

# KY-6, 6CN Type Strainer

Stainless steel, flanged

Y-shaped, flanged strainer made of cast iron, with compact body, large filtering area, is ideal to use in the pipeline where automatic valves are installed. KY-6CN Type has nylon coating for improved corrosion resistance.

## SPECIFICATIONS

Type	Multipurpose type	Nylon coating
Model name	KY-6	
Code name	KY6-G2	KY6-G □*1
	※ 1, 3 or 4 for mesh is required in □.	
Size	15~250(1/2"~10")	15~150(1/2"~6")
Applicable fluid	Steam, gases & liquids Water	
Applicable pressure	Max. 1.0MPa	
Applicable temperature	Max. 184°C*2	5~60°C
End connection	Flanged JIS 10KRF	
Materials	Body(Cast iron), Net(Stainless steel) Cover(Size 15~40mm:brass, Size 50~250mm:Cast iron)	Body(Cast iron), Net(Stainless steel) Cover(Size 15~40mm:Cast bonze, Size 50~65mm:Brass, Size 80~150mm:Cast iron)
Mesh	60 Mesh	※ 1:40 Mesh 3:80 Mesh 4:100 Mesh
Pressure test	Hydraulic 1.5MPa	Hydraulic 1.75MPa
Painting or coating	For Body Interior:Rust proof oil, Exterior:Silver	Body and cover:Nylon 11 coating

\* 1. Size 100mm and bigger, code name is KY6-G Type.

\* 2. Applicable temperature Max. 220°C is available upon your request.

\* 3. Punched plate without lining is available upon your request. (Size 15~40mm: φ 1.3 P2.5. And size 50~250mm: φ 2.5 P4)

## DIMENSIONS

Size	15(1/2")	20(3/4")	25(1")	32(1 1/4")	40(1 1/2")	50(2")	65(2 1/2")	80(3")	100(4")	125(5")	150(6")	200(8")	250(10")
L	125	140	160	180	190	220	270	315	370	450	510	620	760
H	55	67	78	97	112	125	155	200	245	300	340	450	550
Mass(kg)	2	3	4	5.5	6.5	9	13	20	32	55	75	130	220

Flange code JIS 10KRF

## PRESSURE LOSS CHART (punch hole (punch plate))

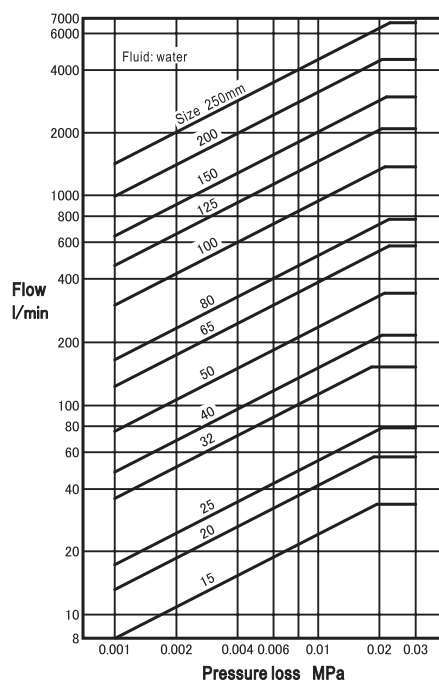

Note: The pressure loss for each mesh number can be calculated by multiplying pressure loss determined using the above chart and a multiplier listed.

## MULTIPLIER LIST

Mesh	Multiplier
40	1.08
60	1.12
80	1.16
100	1.20

\* Refer to page 185 for mesh date.

## CONSTRUCTION

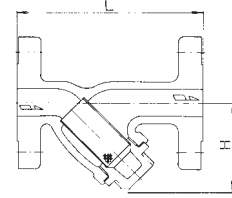

Size 15~40mm

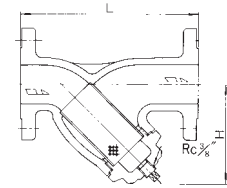

Size 50~65mm

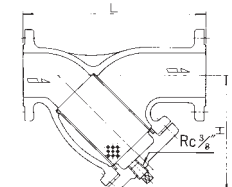

Size 80~250mm

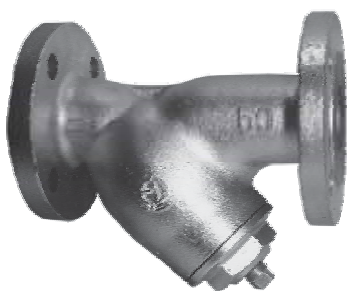

KY-6 Type



KY-6CN Type

## CAUTIONS ON INSTALLATION AND HANDLING

Apply thermal insulation on KY-6CN Type if the temperature difference between the product and the ambient environment is larger than 40°C.